



PRODUCT OVERVIEW

PRESSURE MEASUREMENT

MAC Sensor Co., LTD.

Changsha City, Hunan, China

<http://www.macsensor.com>

TEL: +86-731-89975636 / 89975645

P92 Frequency Conversion Water Supply Pressure Transducer

PROFILE

The P92 pressure transducer owns a compact size. Thanks to the high-integration bridge pressure sensor and advanced signal conditioning chip used, it provides high accuracy and stability. Its IP rating is IP68, providing good sealing performance.

P92 offers temperature compensation in full temperature zones. It is dedicated for water treatment with strong resistance to hammer impact. The product is compliant with high quality standards and passes TUV, CE certification.



CHARACTERISTICS

- ☆ Accuracy: $\leq \pm 1.0\% \text{F.S.}$
- ☆ Wide working temperature scope $-20^{\circ}\text{C} \sim 80^{\circ}\text{C}$
- ☆ Temp. compensation in all temperature zones
- ☆ Excellent long term stability
- ☆ End position injection molding, protection class IP68
- ☆ Built-in air guide, no deviation in gauge pressure
- ☆ Good electrical performance

APPLICATION

- ★ Ink-jet printer
- ★ Variable frequency pump
- ★ HAVC system
- ★ Air-conditioner
- ★ Refrigerators and compressor
- ★ Water pumps
- ★ Petroleum & chemical industry

SPECIFICATIONS

Model Parameter	P92
Pressure Range	-1-10~40 Bar
Overload	150% F.S.
Burst Pressure	200% F.S.
Electronic Wire	3 wires
Output	0.5~4.5V ratiometric
Power Supply	5VDC
Accuracy	±1.0%F.S
Stability	0.3%F.S/year
Medium Temp.	-20~80℃
Working Temp.	-40℃~85℃
Temperature Compensation	-10~70℃
Insulate resistance	>100MΩ/250VDC
Electronic connection	Direct cable outlet
Pressure connect port	G1/4", others on request
Frequency response	>1kHz
Mechanical vibration	10g RMS,(20~2000)Hz
IP rating	IP68

DIMENSION AND DRAWING

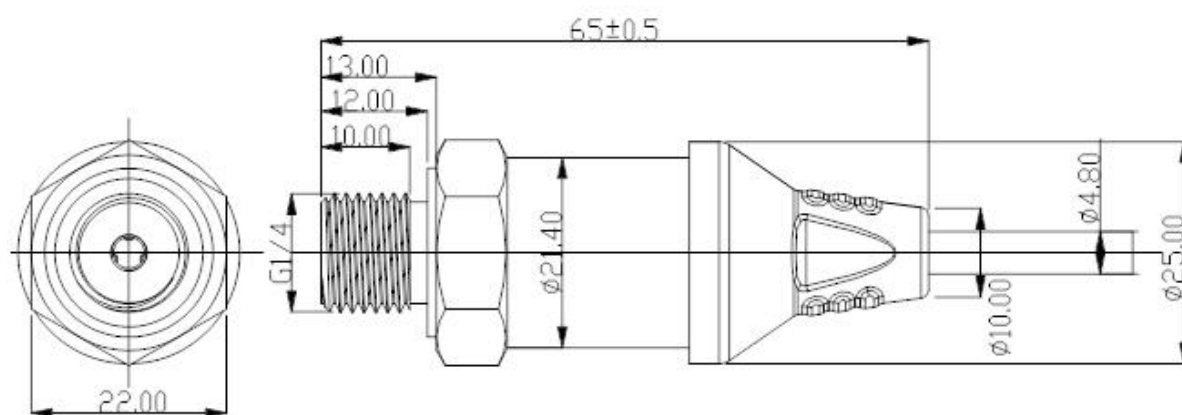

Unit, mm

ELECTRONIC CONNECTIONS

Electronic Wire Connections

	0.5~4.5V	Red	Power+
		Yellow	NC
		Black	GND
		White	Signal

PART NUMBER CODE TABLE FOR PRESSURE RANGE

000	-1-0	016	0-1.5	032	0-10		
001	-1-1	017	0-1.6	033	0-12		
002	-1-9	018	0-1.7	034	0-15		
003	-1-10	019	0-1.8	035	0-16		
004	-1-16	020	0-1.9	036	0-20		
005	-1-20	021	0-2.0	037	0-25		
006	-1-25	022	0-2.1	038	0-30		
007	-1-30	023	0-2.2	039	0-35		
008	-1-35	024	0-2.3	040	0-40		
009	-1-40	025	0-2.5	X	By customized		
010	-1-65	026	0-3				
011	0-0.5	027	0-4				
012	0-1.0	028	0-5				
013	0-1.1	029	0-6				
014	0-1.2	030	0-7				
015	0-1.3	031	0-8				

ORDER INFORMATION

P92 SELECTION	B	8	6	6	036	0	040
Pressure Unit	B=bar M=MPa						
Output	8= 0.5-4.5V X= By Customized						
Power Supply	6=5VDC ±5%						
Process Connection	6=G1/4"male X=By customized						
Pressure Measurement	Refer to <i>PART NUMBER CODE TABLE FOR PRESSURE RANGE</i> on previous page and select your requested range code here.						
Accuracy	0=1%F.S X=By customized						

Cable length 000=Non-cable 040=40cm cable X=By customized